

**Subject** ➤ Addition of Washer 4 and change of Screw 5

**For Models** ➤ 1050D

**Description** ➤ As illustrated below, Washer 4 has been added for improvement of endurance, accordingly Tapping screw has been changed.

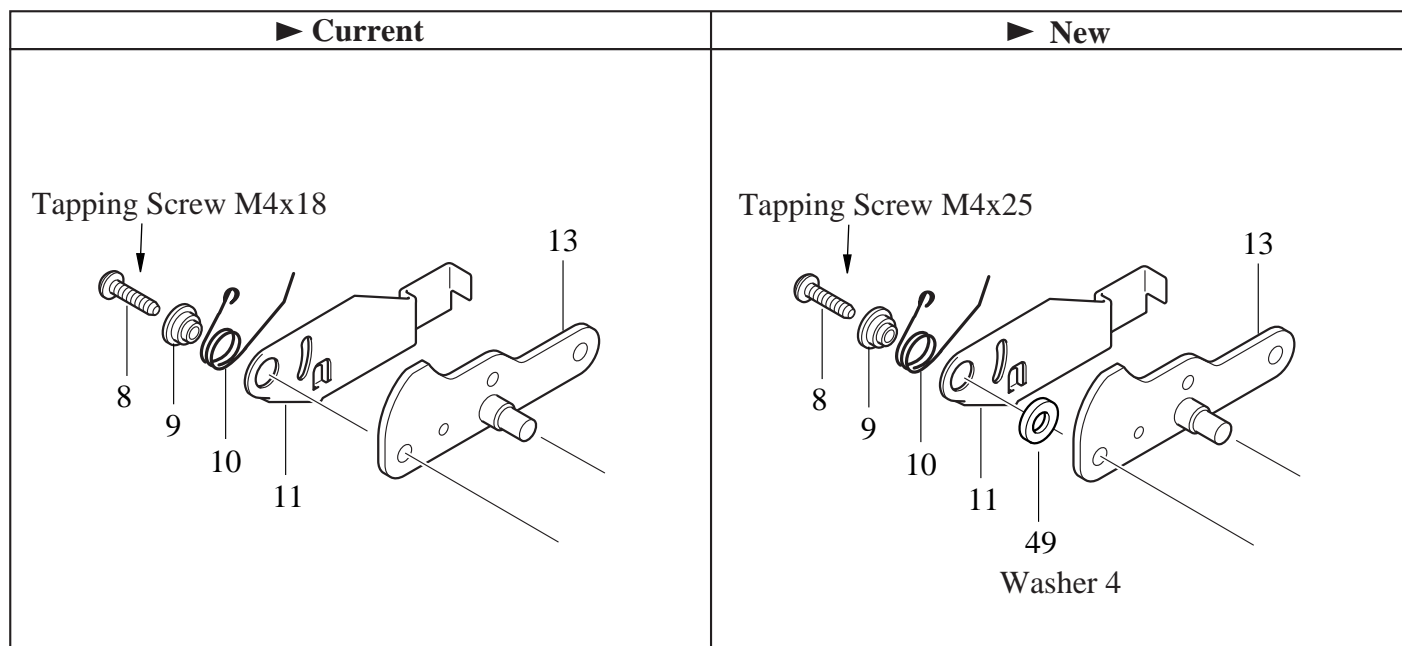

## Interchangeability(I/C)

Item No.	Current part		Q'ty	I/C	New part		Q'ty	Note
8	Tapping Screw M4x18 265995-6		1	<=	Tapping Screw M4x25 265999-8		1	
25	Pan Head Screw M4x25 9111148-2		1	<=	Pan Head Screw M4x30 9111158-9		1	For attaching Set Plate
49					Washer 4 941051-3		1	

## Note

Interchangeability Mark: <= means that the New part can be substituted for the current.

## Implementation

1050D : From serial No.1001E